



## Church Close, Edgware, HA8

**£2,500 Per Month**

Cosway Estates are pleased to offer for rent this beautifully positioned three/four bedroom semi-detached family home located in a peaceful cul-de-sac. The property combines a tranquil family environment with outstanding convenience, within walking distance of both Edgware and Mill Hill Broadway high streets and excellent transport connections into Central London.

On the ground floor, the property comprises of a separate modern fitted kitchen; spacious living room and a fourth bedroom/home office, complete with its own shower room and WC.

Upstairs, the property comprises of three well-proportioned bedrooms and bathroom. The property also benefits from having a lovely rear garden with decking area and driveway. AVAILABLE NOW. Viewings highly advised.

- Three/Four Bedrooms
- Two Bathrooms
- Quiet Cul-De-Sac Location
- Off-Street Parking
- Plenty Of Potential To Extend
- Ideal Family Home
- Reception - Dining Room
- Close To Local Schools & Amenities

### Viewing

Please contact our Mill Hill Office on 02089590011 if you wish to arrange a viewing appointment for this property or require further information.



3



2

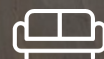

2



D

## Floor Plan

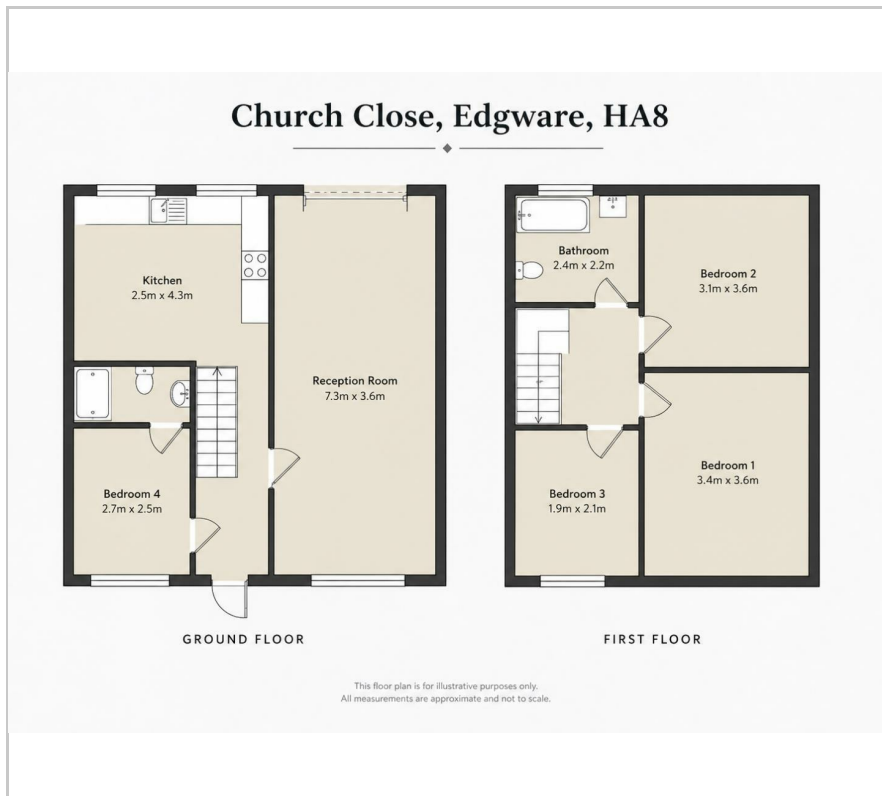

## Area Map

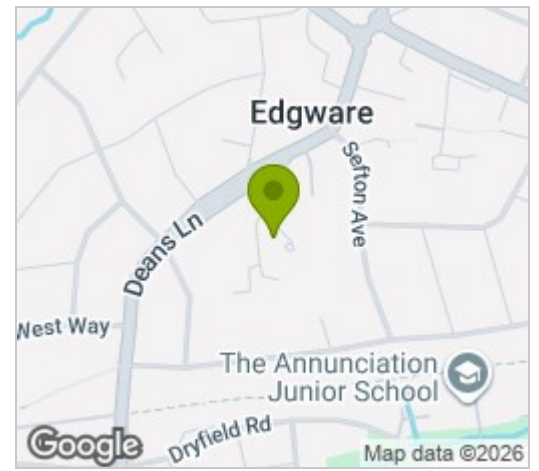

## Energy Efficiency Graph

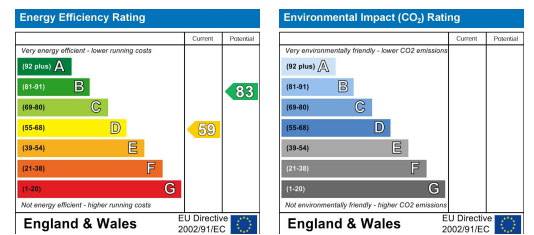

These particulars, whilst believed to be accurate are set out as a general outline only for guidance and do not constitute any part of an offer or contract. Intending purchasers should not rely on them as statements of representation of fact, but must satisfy themselves by inspection or otherwise as to their accuracy. No person in this firm's employment has the authority to make or give any representation or warranty in respect of the property.